

FOR LEASE



**Unit 102 - 799 Notre Dame Ave.
SUDBURY, ONTARIO**



Unit 102 - 799 Notre Dame Ave.
SUDBURY, ONTARIO





Unit 102 - 799 Notre Dame Ave.
SUDBURY, ONTARIO

LOCATION

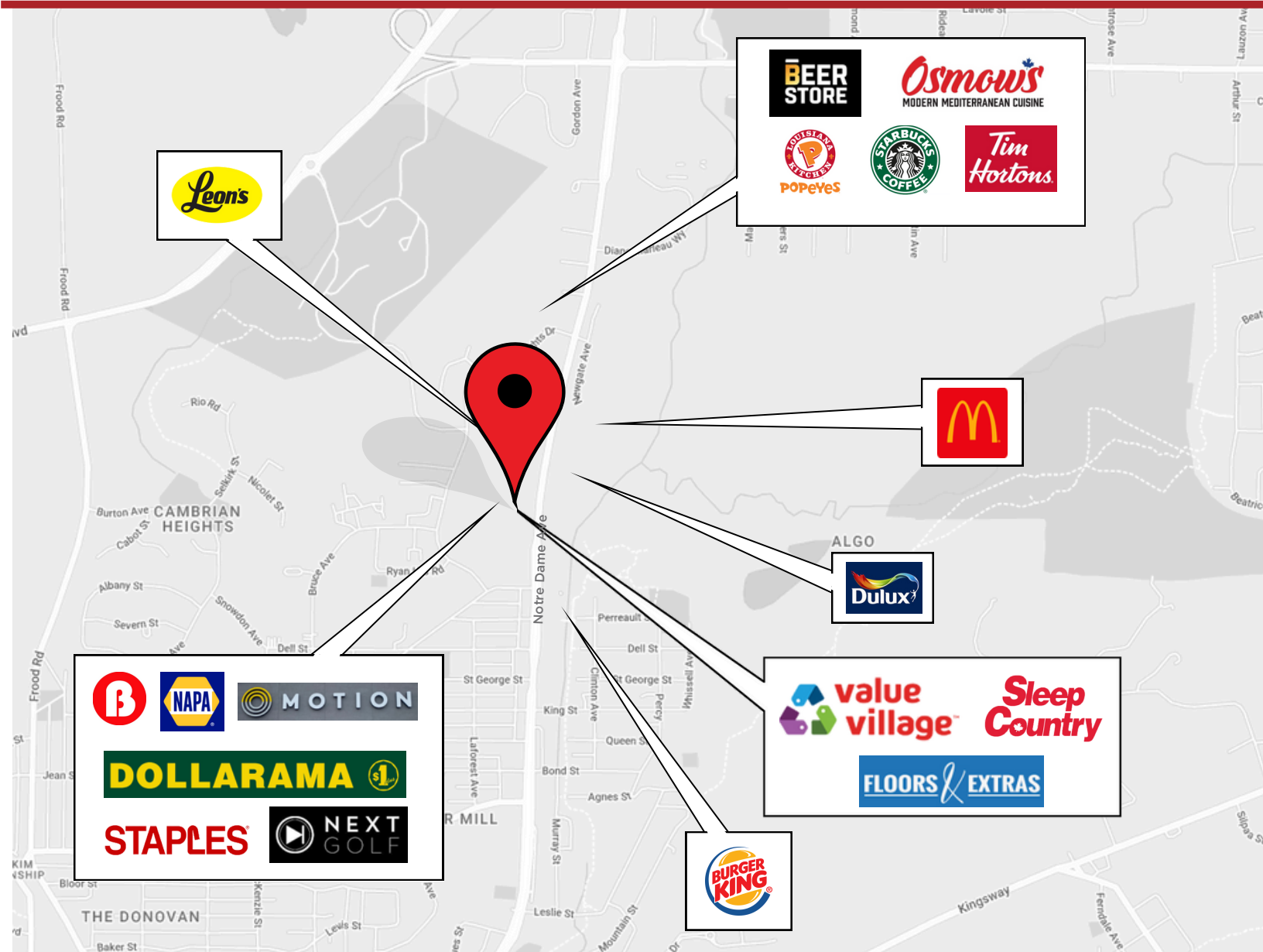

Information contained herein has been obtained from sources that we deem to be reliable but is not warranted as such and does not form any part of any future contract. This offering may be altered or withdrawn at any time without notice.



Unit 102 - 799 Notre Dame Ave. SUDBURY, ONTARIO

UNIT 102 - 19,150 square feet

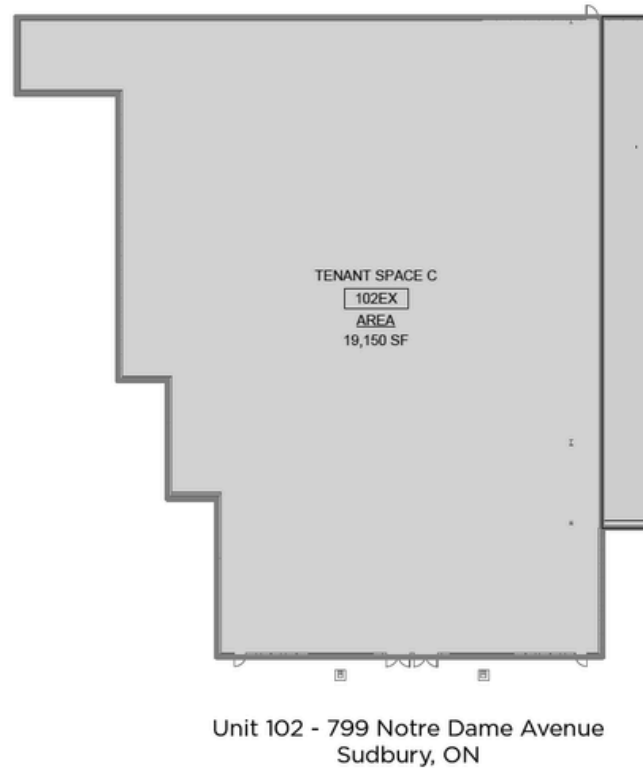

THE ATTACHED DRAWINGS ARE PROVIDED FOR INFORMATION PURPOSES ONLY AND SHOULD NOT BE RELIED UPON. THE LANDLORD SHALL NOT BE HELD RESPONSIBLE FOR THE PURPOSE OF THE TENANT'S WORK AND SPACE PLANNING.

UNIT OVERVIEW

This prime, nationally anchored retail unit is positioned on Notre Dame Avenue — one of Sudbury's busiest retail and traffic corridors, connecting the South end and Downtown to the thriving New Sudbury area.

This end-cap space offers approximately 19,150 sq. ft. of gross leasable area with impressive 14-16 ft. ceiling heights, two loading docks with levelers, excellent street exposure, and plenty of on-site parking for customers and staff.



Unit 102 - 799 Notre Dame Ave.
SUDBURY, ONTARIO

SITE PLAN



THE ATTACHED DRAWINGS ARE PROVIDED FOR INFORMATION PURPOSES ONLY AND SHOULD NOT BE RELIED UPON. THE LANDLORD SHALL NOT BE HELD RESPONSIBLE FOR THE PURPOSE OF THE TENANT'S WORK AND SPACE PLANNING.



Unit 102 - 799 Notre Dame Ave.
SUDBURY, ONTARIO

SITE PLAN

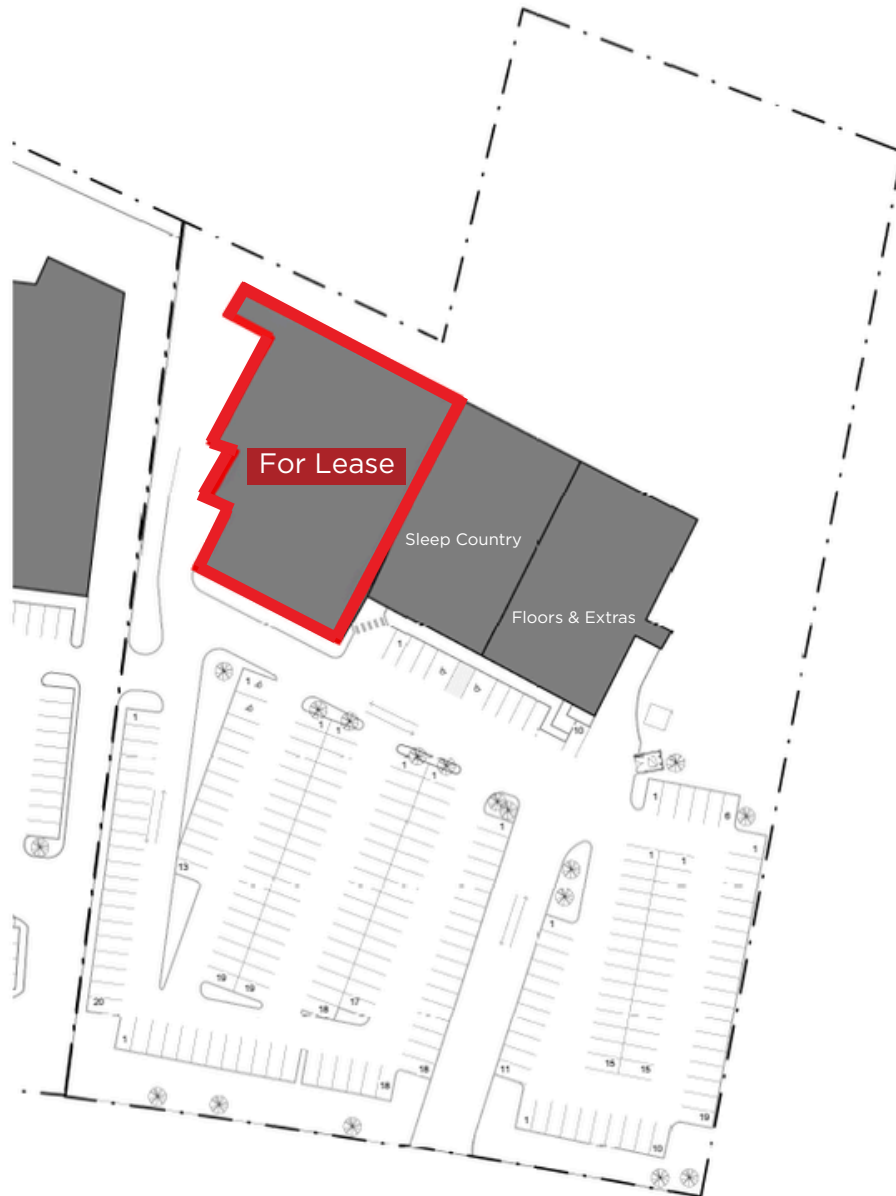

THE ATTACHED DRAWINGS ARE PROVIDED FOR INFORMATION PURPOSES ONLY AND SHOULD NOT BE RELIED UPON. THE LANDLORD SHALL NOT BE HELD RESPONSIBLE FOR THE PURPOSE OF THE TENANT'S WORK AND SPACE PLANNING.